



PROSPECTUS

2025 - 26

Reaccredited NAAC 'B++' (CGPA : 2.85)



- VISION -

Empowerment of Girl Students in Pursuit of
Knowledge, Values and Self - reliance

Shikshan Mandal, Karad's

Mahila Mahavidyalaya, Karad

Affiliated to Shivaji University, Kolhapur

'Empowerment of Girl Students in Pursuit of Knowledge, Values and Self-Reliance'

Shikshan Mandal Karad's

Mahila Mahavidyalaya, Karad

Dist. Satara. 415 110 Maharashtra

e-mail: karadmahila@gmail.com | Website: www.mahilamahavidyalaya.com



Welcome to Shikshan Mandal, Karad's **Mahila Mahavidyalaya, Karad**, the first women's college in Satara district affiliated to Shivaji University, Kolhapur. Being a girls college, it sincerely aims at empowering girl students through an access to modern, scientific and value based higher education, along with a training in employment-oriented skills, and availing them of employment or entrepreneurial opportunities so as to make them self-reliant. The college is committed towards the parents, the potential employers and to the wider society to build a human resource that can be an asset to the nation. Come and join us... your future starts here...

Vision

Empowerment of Girl Students in Pursuit of Knowledge, Values and Self-Reliance

Mission

Mahila Mahavidyalaya endeavours to empower girl students to be self-reliant and thereby a national asset by integrating values, providing quality education and skill development programmes.



महाराष्ट्र राज्य
उच्च व तंत्र शिक्षण विभाग
व महाराष्ट्र माहिती तंत्रज्ञान सहायता केंद्र
यांच्या संयुक्त विद्यमाने

करिअर कट्टा

सुवकांल्ला सवर्णीण विकाससाठी.....

आयएस आपल्या भेटीला

- * राज्य पातळीवरील स्पर्धा परीक्षा/महाराष्ट्र लोकसेवा आयोग
- * पोलीस भरती
- * बँकिंग सेवा
- * स्टाफ सिलेक्शन कमिशन
- * केंद्रीय पातळीवरील स्पर्धा परीक्षा (बु.पी.एस.सी.)

उद्योजक आपल्या भेटीला

- * उद्योजकीय व्यक्तिमत्व विकास
- * व्यवस्थापकीय कौशल्य व प्रत्यक्ष उद्योजकांचे मार्गदर्शन
- * वित्त व्यवस्थापन
- * निर्णय क्षमता
- * जोखीम व्यवस्थापन (Risk Management)
- * मनुष्यबळ व साधनसामुग्री व्यवस्थापन
- * आधुनिक तंत्रज्ञान

ध्येयाच्या वाटेवर साताऱ्याने ३६५ दिवस

३६५ रूपांमध्ये १००० दिवस, मार्गदर्शन ५० add on कोर्सेस मोफत

नाव नोंदणी व अधिक माहितीसाठी ७५०७६५२५५५ या नंबरवर आपले नाव करा

(Draft to include in Prospectus)

Career Katta

(Career and Entrepreneurship Counseling, Skill Development, Internships, Placement, etc.)

Career Katta is an initiative of Department of Higher and Technical Education, Govt of Maharashtra and in coordination with Maharashtra Information Technology Support Centre. The college conducts various activities to guide students about Career, Competitive Examinations (UPSC, MPSC, Banking, SSB, SSC, Police, LIC, etc.), Entrepreneurship, Skill Development; Credit Earnings under new CBCS and NEP Curriculum Framework, Internship and Placement Opportunities, etc.

Eligibility to Join:

Any student admitted for any regular course in the college or college alumni referred by College Coordinator.

Registration Fees: One Time Rs. 365 for Three-year degree period (Rs. 0.36 per day), which will be reimbursed in the form of subsidy on examination charges of CBCS. It including free access to all the activities, courses, State Level Competitive Exams, etc.

How to Register: Download the Career Katta application from Google Play Store and pay fees using any online payment mode

College Code:(Please include the AISHE code of the College)

Contact: For more details visit college webpage _____ or **contact** Coordinator _____ or Career Katta Helpline 75076 52555

करियर कट्टा मध्ये
विद्यार्थ्यांनी नाव नोंदणी
करण्यासाठी

SCAN ME



यूट्यूब वरील उपक्रमांमध्ये
सहभागी होण्यासाठी
सबस्क्राईब करा

Subscribe me



करियर कट्टा नियमित उपक्रमाची
माहिती मिळवण्यासाठी
सबस्क्राईब करा



@MITSCLIVE

हेल्पलाइन नंबर : 750 765 2555



Rs. 100/-

CONTACT

I/C Principal Dr. S. R. Prabhune
Mahila Mahavidyalaya, Karad.

Mangalwar Peth, Karad 415110. Contact No.: 02164 – 220849

E-mail: karadmahila@gmail.com | Website: www.mahilamahavidyalaya.com

- INDEX -							
Sr. No.		Title		Sr. No.		Title	
1		About the Parent Institution	01		15.9	Drinking Water	
2.		Dignitaries of the Parent Institution			15.10	Sanitary Napkin Vending Machine and Incinerator	
3.		About the College			16.	NSQF Courses approved by UGC, Delhi	23
4.		NEP(National Edu. Policy 2.0)	03		17.	Employment Oriented Courses Conducted in the College	
5		Academic Calendar	05		18.	Balwadi Teachers Training Course	
6		Admission Guidelines			19.	Extension Programmes	24
		5.1 General Guidelines			19.1	Competitive Exam. Guidance Centre	
		5.2 Instructions			19.2	National Service Scheme (N.S.S.)	
7		Eligibility	06		19.3	Students Counselling Centre	
8		Documents Required for Admission	07		19.4	Placement Cell	
9.		ABC ID	08		19.5	Equal Opportunity Centre	
10.		Fee Concession	10		19.6	Green Club	
		Documents Required for fee concession			20.	Students Welfare	25
1.		Courses offered–			20.1	Students Welfare Fund	
		11.1 Faculty of Arts			20.2	Scholarships	
		11.1.1 B.A.I			20.3	Students' Health Check-up	
		11.1.2 B.A.II	10		21.	Shivaji University, Kolhapur : Schemes	26
		11.1.3 B.A.III			22.	Food Festival	27
		11.2 Faculty of Commerce			23.	Annual Sports Meet	28
		11.2.1 B.Com.I			24.	Students' Council	
		11.2.2 B.Com.II			25.	Gymkhana	
		11.2.3 B.Com.III	13		26.	Alumni Association	29
		11.3 Faculty of Science			27.	Parents-Teachers Association	
		11.3.1 B.Sc. I			28.	Statutory Committees in the College	
		11.3.2 B.Sc. II			28.1	College Development Committee	
		11.3.3 B.Sc. III			28.2	Internal Quality Assurance Cell (IQAC)	
		11.4 B.Com. (I.T.)			28.3	Special Cell Standing Committee	
		11.4.1 B.Com. I (I.T.)	19		28.4	Grievances Redressal Committee	
		11.4.2 B. Com II (I.T.)	20		28.5	Students' Grievances Redressal Cell	
		11.4.3 B.Com III (I.T.)	21		28.6	Anti-Ragging Committee	
		11.4 M.A. I& II (Geography)	22		28.7	Internal Complaints Committee	
12.		OJT – On Job Training	19		29.	Right to Information Cell	
13.		Fee Chart for year 2025-26	20		30.	Discipline and Code of Conduct	30
14.		Employment Oriented Courses	21		30.1	Code of Conduct for Students	
		14.1 Value - added Courses			30.2	Code of Conduct for Teachers	
15.		Facilities in the College	22				
		15.1 Library					
		15.2 Hostel					
		15.3 Canteen					
		15.4 Computer Lab					
		15.5 Language Lab					
		15.6 NTA Centre					
		15.7 Gymnasium					
		15.8 Ground					
PROSPECTUS - 2025 - 26							

MAHILA MAHAVIDYALAYA, KARAD

1. About the Parent Organisation, Shikshan Mandal, Karad:

The visionary citizens of Karad charged by patriotic fervour offered a fitting tribute to the departed freedom fighter Lokmanya Bal Gangadhar Tilak by founding Shikshan Mandal, Karad on August 1, 1920. Concern for quality education, social service and excellence in extramural activities have permeated through its existence. The following members are at its helm at present:

2. Governing Body of Shikshan Mandal, Karad:

Dr. Shri. Anil Dinkarrao Huddedar	President
Shri. Umeshkumar Ramvilas Lahoti	Vice- President
Dr. Shri. Hemant Prabhakar Tamhankar	Vice- President
Shri. Abhay Devidas Bhandari	Vice- President
Shri. B.M. alias Balasaheb Kulkarni	Chairman
Smt. Anagha Ashok Parandkar	Vice Chairman
Shri. Chandrashekhar Mahadev Deshpande	Secretary
Shri. Rajendra Vidyadhar Latkar	Joint Secretary
Shri. S.P. alias Balasaheb Patil	Council Member
Shri. Arvind Trimbak Ghate	Council Member
Shri. Balawant Narayan Budhkar	Council Member
Shri. Sudhir Vyankatesh Ghate	Council Member
Shri. Kashinath Dattatraya Kulkarni	Council Member
Shri. Madhav Bhalchandra Kumathekar	Council Member
Smt. Dr. Meena Milind Pendharkar	Council Member
Shri. Uday Vilasrao Thorat	Council Member
Shri. Vikram Vishwas Kulkarni	Council Member

3. About Mahila Mahavidyalaya, Karad:

Established on August 7, 1986, Mahila Mahavidyalaya, Karad, an affiliate of Shivaji University, Kolhapur is the first women’s college in both Karad and the entire Satara district. Karad, known for its progressive educational culture, has a population committed to providing higher education for their daughters. Recognizing the importance of women’s empowerment and self-reliance in their chosen fields, the visionary leadership of Shikshan Mandal, Karad took a significant and forward-thinking step by founding Mahila Mahavidyalaya in the heart of the city. Under the dynamic leadership of its founding Principal, Shri A. R. D’souza, the college made remarkable progress, achieving permanent affiliation in 1994 and securing recognition from the UGC in 1998. The college’s growth has been supported by an efficient administrative team, a dedicated and skilled teaching faculty, committed students, and a supportive non-teaching staff. Together, they have fostered a scholarly environment focused on meeting the academic and personal development needs of women. The institution remains committed to providing value-based and skill-oriented quality education while ensuring a safe and supportive campus for all. In recognition of its sustained efforts toward academic excellence, the college was awarded a B++ Grade with a CGPA of 2.85 in its fourth NAAC accreditation cycle in February 2025. In line with its vision

MAHILA MAHAVIDYALAYA, KARAD

and mission, the college is dedicated to nurturing women who are not only deeply rooted in their culture but also equipped with a global outlook - confident, capable individuals who embrace and vibrantly celebrate diversity in all its aspects.

The college offers undergraduate courses in three streams – Arts, Commerce and Science. It has 6 departments at B.A. III level – English, Marathi, Hindi, Economics, Psychology and Geography and 4 departments at B.A. II level – Home-Science, Political Science, Sociology and Physical Education. In the Science stream, third-year B.Sc. students have the option to specialize in either Microbiology or Computer Science. The B.Com. (I.T.) programme offers students both business and tech expertise. The college also offers post-graduate course in Geography. The department of Geography efficiently runs a Research Laboratory affiliated to Shivaji University, Kolhapur. Research scholars pursuing Ph.D. can avail of the laboratory facilities. The medium of instruction for all courses is Marathi, except for the subjects - English and Hindi where the medium of instruction is English and Hindi respectively. For Science, B.Com. (I.T.) and M.A. (Geography) the medium of instruction is English.

Since its inception, the college has consistently evolved to keep pace with the changing world, striving to provide students with a rich and meaningful learning experience. Emphasizing holistic development, the institution engages students through a wide range of curricular, co-curricular, and extra-curricular activities. These include study circles, the NSS, cultural programmes, annual sports events, study tours, research projects, excursions, and guest lectures by eminent scholars on diverse topics. The college also organizes initiatives such as the Food Festival, Health Check-up Camps, Career Guidance Sessions, and Counselling services. Student involvement is further enhanced through active participation in clubs and activities like the Red Ribbon Club, Green Club, and Career Katta, all designed to foster personal growth, social responsibility, and career readiness. Skill Development and Employment Oriented Courses conducted by the Centre for Skill Development are the strength of the college. The centre runs a number of courses at very low fees with an objective to boost students' innate skills. It offers scope for entrepreneurship development and create job opportunities for our girl students. The college runs Balwadi Teachers Training Course of Dept. of Life-long Learning, Shivaji University, Kolhapur, Tally with GST course of

Community Development Centre of Shivaji University, Kolhapur and a Competitive Examinations Guidance Centre. The college has three NSQF courses approved by the UGC, New Delhi and the University: Diploma Course in Food Technology, Certificate Course in Communication in English and Certificate Course in Yoga and Fitness. The efforts of the college in grooming the students for their academic and extracurricular activities fairly reflect in their results and awards in various academic and non-academic

MAHILA MAHAVIDYALAYA, KARAD

activities. Every year our students win University Merit and State Merit Scholarship as well as awards in other extramural activities.

Samvadini, the Magazine of the college is released every year to encourage creative writing in students. The students and the faculty are offered sufficient quality amenities such as computerised Library, Language lab, Reading Room, Computer Lab with Internet Facility, free wi-fi facility to students and teachers, science labs, textile lab, open-air theatre, well-equipped Gymnasium, Yoga room, Class-rooms with LCDs and Interactive Boards, Canteen, etc. to meet the multiple educational needs. The NTA centre facilitates students, off campus included, to appear for various competitive, entrance, etc. exams. The college has a well-equipped and well-managed UGC funded hostel accommodation for girls with necessary amenities. Administration (maintenance of accounts, admission process, correspondence, issuance of certificates like bonafide, character, salary, etc.) is fully computerized. Mahila Mahavidyalaya is the only college in the jurisdiction of Shivaji University, Kolhapur that begins with a Prayer, Maharashtra Geet and National Anthem. The Prayer is printed on the back page of the prospectus.

4. NEP

Mahila Mahavidyalaya, Karad follows the NEP guidelines laid down by the UGC and the government of India. The NEP 2020 aims to transform India’s education system by emphasizing holistic development, multidisciplinary learning, and a more flexible and inclusive approach to education. It seeks to foster critical thinking, creativity, and problem-solving skills, while also reducing the burden of exams and rote learning. The policy also aims to inculcate compassion and empathy, courage and resilience, scientific temper and creative imagination, with sound ethical moorings and values in an individual. Moreover, it intends to produce engaged, productive, and contributing citizens for building an equitable, inclusive, and plural society by increasing access to education for all, particularly for marginalized and disadvantaged groups, and to prepare them for global landscape.

Special Features:

- Students’ Career Centric programme
- Three / Four Year Multidisciplinary Bachelor’s Degree Programme with honours
- Provision for Five- Year Integrated PG Programme with continuation of Ph.D.
- Completely Research based Second year PG programme
- Choice for Major and Minor subjects
- Choice based cross-disciplinary, trans-disciplinary & multi-disciplinary
- MEME – Multiple Entry (at Sem. 3&5) and Multiple Exit (at Sem.2 &4) Option for lateral entry
- Admission to any university at any level
- Provision of ABC ID for Credit transfer
- Provision of Bridge Course to meet the required credits for next level programme
- Total Programme duration seven years (as per students’ choice)
- Emphasis on innovation, Entrepreneurship development & enhancing employability skills

MAHILA MAHAVIDYALAYA, KARAD

- Outcome based curriculum framework
- Focus on Internships, Rigorous Field & Research Projects, Apprenticeship
- Emphasis on strong industry – academia linkages
- Additional courses on Environmental studies, Value education, Professional ethics, Life Skills, etc.
- CUTE – Common University Entrance Test for admission across the country
- NTA (National Testing Agency) – a single window system for admissions
- Provision for career counselling after 12th standard
- Provision for Dual Degree programme (UGC)
- Focus on Experiential learning for language acquisition
- Promotion of Bilingual learning or learning in local languages
- Emphasis on Language Literacy
- Encouragement to co-curricular courses – Sports, Fine/Applied/Visual Arts & Cultural Activities
- Provision for Open & Distance Learning (ODL) through CDOE (Centre for Distance & Online Learning)
- Encouragement to SWAYAM & NPTEL courses

Structure of Higher Education in NEP 2020

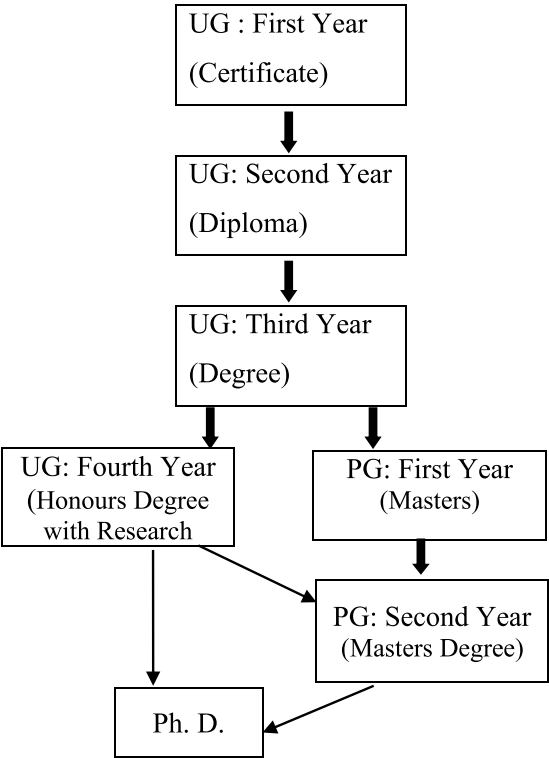

MAHILA MAHAVIDYALAYA, KARAD

Abbreviations

CBCS : Choice Based Credit System	AEC : Ability Enhancement Course
CC : Co-curricular Courses	CEP : Community Engagement Programme
CGPA : Cumulative Grade Point Average System	DSC : Discipline Specific Core Subject
DSE : Discipline Specific Elective Subject	FP : Field Project
Gen. : Generic	IKS : Indian Knowledge System
OE/GE: Other / Geberic Elective	OJT : On Job Training
SEC : Skill Enhancement Course	VSC : Vocational Skill Course
SGPA: Semester Grade Point Average	VEC: Value Education Course

5. Academic Calendar:

Commencement of the Academic Year 2024-25: 16 June 2025

🕒 College Hours:	7.45 a.m. to 12.45 p.m.
🕒 Office Hours:	8.00 a.m. to 4.00 p.m.
🕒 Holidays:	As per the notifications of the University

Note: As per the directives of the UGC (30/06/2010 Section 14), Admission of the students and Examination shall be included in the period between Commencement of the First Semester and end of the Second Semester.

6. Admission Guidelines:

6.1. General:

- Admission to B.A., B.Com. B.Com. (I.T.), B.Sc. and M.A (Geography) courses shall be given as per the rules and regulations of the University and Government.
- Students who have passed H.S.C. examination in Arts / Commerce stream shall be admitted to B.A. Part I, B.Com. Part I, B.Sc. Part I and B.Com. (I.T.) Part I classes respectively.
- Students who have passed H.S.C. examination from science faculty can seek admission to B.A. Part I.
- Students who have done D.Ed. with English as one of her subjects can seek admission to the B.A. Part I.
- An Arts graduate with Geography as a special subject at B.A. Part III can seek admission to M.A. Part I (Geography) after passing the Entrance Test of Shivaji University, Kolhapur.
- The intake capacity for M.A. (Geography) is 20.
- There is separate admission committee for each course.
- The principal reserves the right to amend/modify the admission process as and when amendments / modifications are received from the University, Management or the Government.
- Parents/students are requested to go through the announcements and instructions displayed on the notice board before seeking admission to the college.

6.2 Instructions:

- Admissions shall be given on the basis of merit and as per the rules, regulations and ordinances of Shivaji University, Kolhapur.
- The rules and regulations regarding admission to all classes will be displayed on the notice board.

MAHILA MAHAVIDYALAYA, KARAD

- In case of physically challenged students seeking admission to the first year of the integrated degree course, the Admission Committee may use its discretion subject to the fulfilment of other conditions of admission.
 - Admission committee shall guide the students with admission.
 - Fees for the Courses are mentioned in the Prospectus.
 - Students aiming to enrol for B. A. / B.Com. / B.Sc. / B.Com. (I.T.) I, II, III courses shall submit their duly filled in admission-form along with required documents to the concerned admission committee and keep a photocopy of the same with them.
 - The students shall submit self-attested copies of the certificates to the college along with admission form. They shall not submit their original academic and personal certificates (e.g. marksheets, leaving certificate, etc.) at the time of admission.
 - The students who wish to withdraw their admission in the first semester shall give an application along with a full fee charged for the first semester. The college shall follow the guidelines of the university regarding the same.
 - The students who wish to cancel their admission in the second semester shall give an application along with a full fee charged for the first and second semester.
 - Students shall pay extra Education Fees if the Government of Maharashtra increases the same.
7. **Eligibility:**
- **B.A. Part I:**(NEP 2.0)
Students who have passed H.S.C. or Maharashtra Shikshan Mandal’s 2 Year D.Ed. Course or any other equivalent examination.
 - **B.A. Part II :** (NEP 2.0)
Students who have passed the previous University Examination (B.A.I CBCS and NEP1.0) or have got A.T.K.T.
 - **B.A. Part III:**(NEP 1.0)
Students who have passed previous University Examination (B.A. II CBCS or NEP 1.0) or have got A.T.K.T.
 - **B.Com Part I:** (NEP 2.0)
Students who have passed H.S.C. examination in Commerce or any other equivalent examination.
 - **B.Com Part II:** (NEP 2.0)
 - i) Students who have passed the previous University Examination (B.Com I CBCS or NEP 1.0) or have got A.T.K.T.
 - ii) Students who have done B.A. majoring Economics can directly seek admission for B.Com. II and are given special consideration in the selection of some subjects.
 - **B.Com. Part III:** (NEP 1.0)
Students who have passed previous University Examination (B.Com.II CBCS or NEP1.0) or any other equivalent examination or have got A.T.K.T.
 - **B.Com. (I.T.) Part I** (NEP 2.0)
Students who have passed H.S.C. examination in Arts / Commerce / Science stream with 45% or its equivalent or any Diploma or MCVC of not less than two years shall be admitted to B.Com. Part I (I.T.) NEP 2.0.

MAHILA MAHAVIDYALAYA, KARAD

- **B.Com. (I.T.) Part II:** (NEP 2.0)
Students who have passed the previous University Examination (B.Com. (I.T.) Part I NEP 1.0) or have got A.T.K.T.
 - **B.Com. (I.T.) Part III:** (NEP 1.0)
Students who have passed previous University Examination (B.Com. (I.T.) II NEP 1.0) or have got A.T.K.T.
 - **B.Sc. Part I** (NEP 2.0)
Students who have passed H.S.C. examination in science stream shall be admitted to B.Sc. Part I NEP 2.0
 - **B.Sc. Part II:** (NEP 2.0)
Students who have passed the previous University Examination (B.Sc. Part I NEP 1.0) or have got A.T.K.T.
 - **B.Com. (I.T.) Part III:** (NEP 1.0)
Students who have passed previous University Examination (B.Sc. Part II NEP 1.0) or have got A.T.K.T.
 - **M.A. Part I NEP (Geography):**
Students who have passed B.A. III majoring Geography and those who have cleared the entrance exam of Shivaji University, Kolhapur.
- 8. Documents Required for Admission:**
- Duly filled in Admission Form (attached at the end of the prospectus) along with a passport size photograph affixed in the space provided.
 - Original and two attested photocopies of the Statements of Marks of the qualifying examination along with Std. X and XII Marklist.
 - School / College leaving Certificate – Original and an attested photocopy.
 - Duly filled-in University Eligibility Form along with Rs. 75/- only as Eligibility Fee for B.A/ B.Com./B.Com. (I.T.), B.Sc. Part I and Rs.50/- M.A. for M.Sc. Part I (Admission for a course shall be finalised only after the Eligibility Form is approved)
 - A Letter of Guarantee regarding the Assurance of 75% attendance for all the subjects opted must be submitted along with the Admission Form.
 - Declaration Certificate (attached at the end of the prospectus)
 - Adhaar Card (Attested copy)
 - Students from other universities should submit Migration Certificate to the office. The Migration Certificate can be procured by submitting an application to the previous college. The students can get information regarding the same from the office of the college.
Students cannot change the subjects once selected unless permitted by the Principal.



USER GUIDE TO CREATE ABC ID

Step-1: Download the app Digilocker from Play-store URL : <https://play.google.com/store/apps/details?id=com.digilocker.android>
Create an id in the Digilocker app with the details given in the Aadhar Card



Step 2 Open the Digilocker app

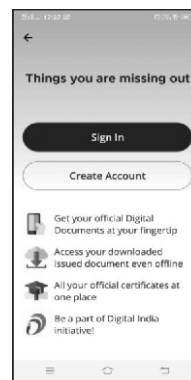

Step-3 : Create account

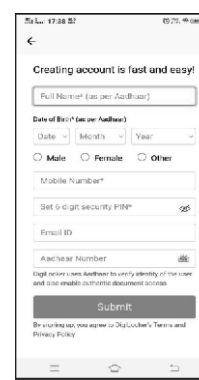

Step 4: Fill all the details according to Aadhar Data

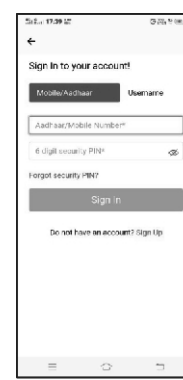

Step-5: Put your mobile number linked with Aadhar as username.



Step-6: Get OTP

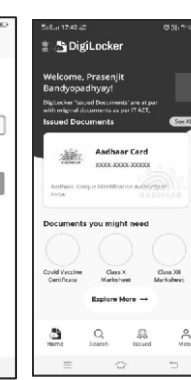

Step-7: Get Digilocker dashboard.

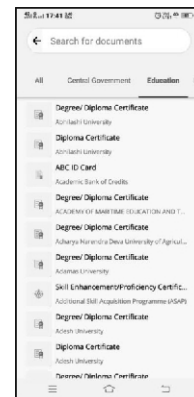

Step-8: Search and tap Education tab and tap Academic Bank of Credit tab

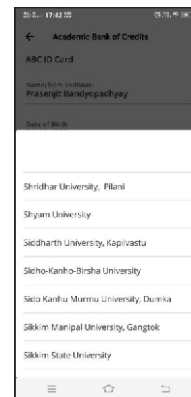

Step-9: Select Institution type as 'University' and Put/Select the name as Shivaji University Kolhapur



Step-10: Get Document

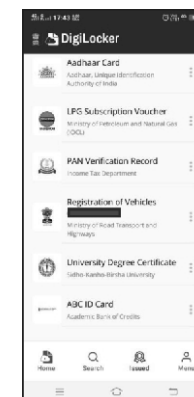

Step-11: See the ABC ID Card in your Issued Document tab



Step-12: Your ABC ID has been created, Share the ABC ID with your College

MAHILA MAHAVIDYALAYA, KARAD

10. Fee Concession:

- Wards of Ex-servicemen/P.T.C./M.T.C./F.F. should submit necessary documents at the time of admission for securing fee concession.
- Students belonging to Economically Backward Class and S.C./S.T./V.J./N.T. etc. category shall submit the required documents for securing fee concession.

10.1 Documents required for Fee Concession:

- 1) Income Certificate duly signed by Tehsildar (Original)
- 2) Domicile Certificate duly signed by Tehsildar (Original)
- 3) Caste Certificate (**only for students of reserved category*)
- 4) Coloured Photo (I/C size – 2)
- 5) Photocopy of Passbook of a Nationalised bank (must be linked with Adhaar Card)
- 6) Photocopy of Adhaar Card (must be linked with Mobile Number)
- 7) Photocopy of Ration Card
- 8) E-mail Id
- 9) Admission Receipt
- 10) Photocopy of School Leaving Certificate
- 11) Photocopy of SSC Exam Marklist and Board Certificate
- 12) Photocopy of HSC Exam Marklist
- 13) Photocopy of Marklist of B.A./B.Com./B.Sc./B.Com. (I.T.) I (Sem I & II)
- 14) Photocopy of Marklist of B.A./B.Com./B.Sc./B.Com. (I.T.) II (Sem III & IV)

11. COURSES:

11.1 FACULTY OF ARTS
11.1.1 B.A. I

Shikshan Mandal, Karad's

Mahila Mahavidyalaya, Karad

ADMISSION FOR ACADEMIC YEAR 2025-2026

NEP-2020 (2.0) : Course Groups for B.A. I, Sem-I (Level 4.5) under Faculty of Humanities

Sr.	COURSE	TITLE OF PAPER	CREDITS
1	DSC 1 (any one) (Major)	MARATHI - रुजुवात / HINDI - आधुनिक न दिमान / ENGLISH - Introduction to English Literature (Short Story) & Language (Word Classes)	4 (80+20= 100 marks)
2	DSC 2 (any one) (Major)	GEOGRAPHY - Physical Geography / ECONOMICS - Indian Economy / PSYCHOLOGY - Psychology for Friendship & Love	4 (80+20= 100 marks)
3	DSC 3 (any one) (Major)	POLITICAL SCIENCE - Indian Constitution / SOCIOLOGY - Introduction to Sociology / HOME SCIENCE - Fundamentals of Food Science & Nutrition / PHYSICAL EDUCATION - Introduction & Promotion of Physical Education & Sports	4 (80+20= 100 marks)
4	OE-1 (any one) (Minor)	COMMERCE - Financial Literacy / Marketing Skills / SCIENCE - Biofertilizers & Manures / Quantitative Aptitude for Competitive Exam	2 (40+10= 50 marks)
5	SEC-I (any one) (Minor)	MARATHI - मि नवकासव भानकि कौशे / HINDI - पकारीता / Geography - Fundamentals of Tourism	2 (40+10= 50 marks)
6	AEC-I (Minor)	COMMUNICATION SKILL-I	2 (40+10= 50 marks)
7	IKS-I (Minor)	INTRODUCTION TO INDIAN KNOWLEDGE SYSTEM (GENERIC)	2 (40+10= 50 marks)
8	CC (Minor)	CULTURAL PROGRAMME / VIVEK VAHINI / YOGA / SPORTS / NSS	2 (40+10= 50 marks)
		Total Credits	22

Shikshan Mandal, Karad's Mahila Mahavidyalaya, Karad ADMISSION FOR ACADEMIC YEAR 2025-2026 NEP-2020 (2.0) : Course Groups for B.A. I, Sem-II (Level 4.5) under Faculty of Humanities			
Sr.	COURSE	TITLE OF PAPER	CREDITS
1	DSC 1 (any one) (Major)	MARATHI – रुजुवात / HINDI – आधुनिक न दिसान / ENGLISH – Introduction to English Literature (Poetry) & Language (Morphology)	4 (80+20= 100 marks)
2	DSC 2 (any one) (Major)	GEOGRAPHY – Human Geography / ECONOMICS – Indian Economy / PSYCHOLOGY – Health Psychology	4 (80+20= 100 marks)
3	DSE 3 (any one) (Major)	POL. SCI. – Indian Government / SOCIO. – Changing Nature of Social Institutions / HOM. SCI. – Resource Management / PHY. EDU. – The Foundation of Physical Education	4 (80+20= 100 marks)
4	OE-1 (any one) (Minor)	COMMERCE – Financial Planning (50) / Digital Marketing / SCIENCE – Gardening Technique (10) / Vermiculture	2 (40+10= 50 marks)
5	SEC-II (Minor)	ENGLISH – Developing Writing Skills in English / PHY.EDU. – Measurement & Evaluation in Physical Education /	2 (40+10= 50 marks)
6	AEC-II (Minor)	COMMUNICATION SKILL-II	2 (40+10= 50 marks)
7	VEC-I (Minor)	WELCOMING DIVERSITY FOR BUILDING SOCIETY: DEMOCRACY, CONSTITUTION & ELECTION (In <u>ONLINE</u> mode)	2 (40+10= 50 marks)
8	CEP (Minor)	MAR-समाजभान / HINDI-सामुदायिक सहभागिता परियोजना / GEO-Acquisition of Social Data / ECO-Social Problems & Social Skills / PSY-Community Mental Health	2 (40+10= 50 marks)
		Total Credits	22

11.1.2 B.A. Part II (NEP 2.0)

For the academic Year 2025-26, admissions shall be as per NEP 2.0 guidelines and subject baskets provided by Shivaji University, Kolhapur.

11.1.3 B.A. Part III (CBCS and NEP 1.0)

Compulsory Subject : English

Optional Subjects: ANY ONE subject as a Special Subject from the optional subjects selected at B.A.II Level :

Marathi / Hindi / English / Geography / Economics / Psychology

- Each Special Subject has 5 papers + English (Compulsory)
- Students shall appear for the following Skill Enhancement Courses Under Graduate CBCS Programme :
- Semester V: Compulsory Civic Course of Self Study Mode – 'Constitution of India'.
- Semester VI:
 - i) Interview & Personal Presentation Skill
 - ii) Entrepreneurship Development Skill
 - iii) Travel and Tourism
 - iv) E-Banking & Financial Services
 - v) RTI & Human Right Education (HRE), IPR & Patents
- Examinations for the above mentioned Self-Study Programmes are compulsory for all B.A. III students.
- The syllabus of the course is available on www.unishivaji.ac.in (student online syllabus)
- The credits achieved by the students shall be separately mentioned in the result sheet.

11.2 Faculty of Commerce

Shikshan Mandal, Karad's Mahila Mahavidyalaya, Karad NEP-2020 (2.0): Course Groups for B.Com. I, Sem-II (Level 4.5) Faculty of Commerce & Management			
Sr. No.	COURSE	DSC-I	CREDITS
1	DSC 1 (Major)	ACCOUNTANCY–II–SINGLE ENTRY & ACCOUNTS OF PROFESSIONALS & NON-PROFIT ORGANIZATIONS	4 (80+20= 100 marks)
2	DSC 2 (Major)	BUSINESS STUDIES–II– INTRODUCTION TO MARKETING	4 (80+20= 100 marks)
3	DSC 3 (Major)	BUSINESS ECONOMICS – II	4 (80+20= 100 marks)
4	OE-II (Minor)	HUMANITIES –MARATHI- साहसतुााीपे / HINDI ोजनमुलक हहंऔर कावताएां SCIENCE –GARDENING TECHNIQUE / VERMICULTURE	2 (40+10= 50 marks)
5	SEC-II (Minor)	MARKETING SKILLS (DIGITAL MARKETING)-II / INSURANCE SKILLS-II	2 (40+10= 50 marks)
6	AEC-II (Minor)	ENGLISH FOR BUSINESS COMMUNICATION-II	2 (40+10= 50 marks)
7	VEC-I (Minor)	WELCOMING DIVERSITY FOR BUILDING SOCIETY: DEMOCRACY, CONSTITUTION & ELECTION (In ONLINE mode)	2 (40+10= 50 marks)
8	CEP (Minor)	ACCOUNTANCY/ BUSINESS STUDIES/ BUSINESS ECONOMICS (Major Related)	2 (40+10= 50 marks)
22 Credits			22
11.2.2 B.Com. Part II (NEP 2.0): For the academic Year 2025-26, admissions shall be as per NEP 2.0 guidelines and subject baskets provided by Shivaji University, Kolhapur.			
11.2.3 B.Com. Part III (CBCS and NEP 1.0): 1. Business Environment 2. Business Regulatory Framework 3. Modern Management Practices 4. Co-operative Development 5. Advanced Accountancy Paper I 6. Advanced Accountancy Paper II • Students shall appear for the following Skill Enhancement Courses Under Graduate CBCS Programme: • Semester V: Compulsory Civic Course of Self Study Mode – 'Constitution of India and Local Self Government'. • Semester VI: i) Interview & Personal Presentation Skill ii) Entrepreneurship Development Skill iii) Travel and Tourism iv) E-Banking& Financial Services v) RTI & Human Right Education (HRE) , IPR & Patents • Examinations for the above-mentioned (SEC) Self-Study Programmes are compulsory for all B.Com. III students. • The syllabus of the course is available on www.unishivaji.ac.in (student online syllabus) • The credits achieved by the students shall be separately mentioned in the result sheet.			
PROSPECTUS - 2025 - 26			

11.3 Faculty Of Science

11.3.1 B.Sc. Part I (NEP 2.0)

Shikshan Mandal, Karad's

Mahila Mahavidyalaya, Karad

NEP-2020 (2.0): Course Groups for B.Sc. I, Sem-I (Level 4.5) under Faculty of Science & Technology

GROUPS	Sr. No.	COURSE	DSC I	DSC II	DSC Pr. I
GROUP-A (Major)	1	COURSE 1	COM. SCI.-I-BASICS OF C PROGRAMMING (2 Credits)	COM. SCI.-II-DATA BASE CONCEPTS (2 Credits)	DSC Pr.-I (2 Credits)
	2	COURSE 2	ELECTRO-I-CIRCUIT ELEMENTS/PHY-I-MECHANICS (2 Credits)	ELECTRO-II-DIGITAL ELECTRONICS/PHY-II-ELECTRICITY & MEGNATISM (2 Credits)	DSC Pr.-I (2 Credits)
	3	COURSE 3	MATHS-I-BASIC ALGEBRA/STAT-I- DESCRIPTIVE STATISTICS (2 Credits)	MATHS-II-CALCULUS/STAT-II- ELEMENTARY PROBABILITY THEORY (2 Credits)	DSC Pr.-I (2 Credits)
	Sr. No.	COURSE	DSC I	DSC II	DSC Pr. I
GROUP-B (Major)	1	COURSE 1	MICRO-I-INTRODUCTION TO MICROBIOLOGY (2 Credits)	MICRO-II-BASIC TECHNIQUES IN MICROBIOLOGY (2 Credits)	DSC Pr.- (2 Credits)
	2	COURSE 2	CHEM-I-INORGANIC CHEMISTRY (2 Credits)	CHEM-II-ORGANIC CHEMISTRY (2 Credits)	DSC Pr.-I (2 Credits)
	3	COURSE 3	BOT-I-PHYCOLOGY & MICROBIOLOGY/ ZOO-I-ANIMAL DIVERSITY (2 Credits)	BOT-II-BIOMOLECULES & CELL BIOLOGY/ ZOO-II-CELL BIOLOGY (2 Credits)	DSC Pr. (2 Credits)
Minor	4	OE-I (any one)	HUMANITIES –1) ECONOMICS OF INDIAN AGRICULTURE / 2) PSYCHOLOGICAL FIRST AID / COMMERCE -1) FINANCIAL LITERACY \ 2) MARKETING SKILLS (2 Credits)		
Minor	5	IKS-I	Interdisciplinary Course in Generic IKS (2 Credits)		
Total			22 Credits		

Shikshan Mandal, Karad's

Mahila Mahavidyalaya, Karad

NEP-2020 (2.0): Course Groups for B. Sc. I, Sem-II (Level 4.5) under Faculty of Science & Technology

GROUPS	Sr. No.	COURSE	DSC-III	DSC-IV	DSC-Pr. II
GROUP-A (Major)	1	COURSE 1	COM. SCI.-III-ADVANCED C PROGRAMMING (2 Credits)	COM. SCI.-IV-ADVANCED DATABASE (2 Credits)	DSC Pr.-II (2 Credits)
	2	COURSE 2	ELECTRO-III-SEMI-CONDUCTOR DEVICES/PHY-III-PROPERTIES OF MATTER (2 Credits)	ELECTRO-IV-DIGITAL ELECTRONICS/PHY-IV-ELECTRICITY & MAGNETISM (2 Credits)	DSC Pr.-II (2 Credits)
	3	COURSE 3	MATHS-III-DIF. EQUATIONS/STAT-III- STATISTICAL METHODS (2 Credits)	MATHS-IV-DISCRETE MATHS/STAT-IV-DISCRETE PROBABILITY DISTRIBUTIONS (2 Credits)	DSC Pr.-II (2 Credits)
	Sr. No.	COURSE	DSC-III	DSC-IV	DSC-Pr. II
GROUP-B (Major)	1	COURSE 1	MICRO-III-BACTERIOLOGY (2 Credits)	MICRO-IV-APPLIED MICROBIOLOGY (2 Credits)	DSC Pr.-II (2 Credits)
	2	COURSE 2	CHEM-III-PHYSICAL CHEMISTRY (2 Credits)	CHEM-IV-ANALYTICAL CHEMISTRY (2 Credits)	DSC Pr.-II (2 Credits)
	3	COURSE 3	BOT-III-MYCOLOGY & PHYTOPATHOLOGY/ZOO-III- GENETICS (2 Credits)	BOT-IV-ARCHEGONATE/ZOO-IV- ECOLOGY, ETHOLOGY, EVOLUTION & ENTOMOLOGY (2 Credits)	DSC Pr.-II (2 Credits)
(Minor)	4	OE-II (any one)	HUMANITIES –MARATHI- साहित्य / चिन्तन / हिंदी / जीवनमूलक हस्तकलाएँ / COMMERCE – FINANCIAL PLANNING / DIGITAL MARKETING (2 Credits)		
(Minor)	5	VEC-I	WELCOMING DIVERSITY FOR BUILDING SOCIETY: DEMOCRACY, CONSTITUTION & ELECTION (In <u>ONLINE</u> mode) (2 Credits)		
Total			22 Credits		

MAHILA MAHAVIDYALAYA, KARAD

11.3.2 B.Sc. Part II (NEP 2.0)

For the academic Year 2025-26, admissions shall be as per NEP 2.0 guidelines and subject baskets provided by Shivaji University, Kolhapur.

11.3.3 B.Sc. Part III - Semester–V& VI

Subject – Microbiology

SEMESTER – V	
Course IX (DSE E 49)	Virology
Course X (DSE E 50)	Immunology
Course XI (DSE E 51)	Food and Industrial Microbiology
Course XII (DSE E 52)	Agricultural Microbiology

SEMESTER – VI	
Course XIII (DSE F 49)	Microbial Genetics
Course XIV (DSE F 50)	Microbial Biochemistry
Course XV (DSE F 51)	Environmental Microbiology
Course XVI (DSE F52)	Medical Microbiology

SCHEME OF TEACHING AND EXAMINATION

(The scheme of teaching and examination should be given as applicable to the course / Paper concerned)

Sr.No.	Subject / Paper	Teaching Scheme (Hrs/Seek)		
		L	P	Total
1	Course – IX and XIII	3		
2	Course – X and XIV	3		
3	Course –XI and XV	3		12
4	Course –XII and XVI	3		
5	Practical I		5	
6	Practical II		5	20
7	Practical III		5	
8	Practical IV		5	
Total				

11.3.3 B.Sc. Part III - Semester– V & VI

Subject – Computer Science

Sr.No.	Paper	Name Of Paper	Marks		
			Theory	Internal	Total
Computer Science (Semester – V)					
1	DSE-E21	Core Java	40	10	50
2	DSE-E22	C# Programming	40	10	50
3	DSE-E23	Linux Operating System	40	10	50
4	DSE-E24	Basics of Python	40	10	50
Computer Science (Semester – VI)					
5	DSE-F 21	Advanced Java	40	10	50
6	DSE-F 22	ASP .NET	40	10	50
7	DSE-F 23	Advanced Linux OS	40	10	50
8	DSE-F 24	Advanced Python	40	10	50
Practical (Annual)					
9	Practical Paper - IV	Computer Science Practical Paper Based on DSE – E 21, E22, F21 and F22	50 (Practical)	-	50
10	Practical Paper - V	Computer Science Practical Paper Based on DSE – E 23, E24, F23 and F24	50 (Practical)	-	50
11	Practical Paper - VI	Software Project	100	-	100

11.4 B.COM. (INFORMATION TECHNOLOGY)

11.4.1 B.Com. (I.T.) Part I NEP (2.0)

Shikshan Mandal, Karad's

Mahila Mahavidyalaya, Karad

NEP-2020 (2.0): Course Groups for B.Com.IT Sem-I (Level 4.5) under Faculty of Commerce & Management

Sr. No.	COURSE	DSC-I	CREDITS
1	DSE 1 (Major)	PROGRAMMING IN C PART-I (Mandatory)	2 (40+10= 50 marks)
2	DSE 2 (Major)	FUNDAMENTALS OF INFORMATION TECHNOLOGY (Mandatory)	2 (40+10= 50 marks)
3	DSE 3 (Major)	LAB ON DSC-1 & VSC-1 (Mandatory)	2 (40+10= 50 marks)
4	OE-1 (Minor)	HUMANITIES – MICRO ECONOMICS	2 (40+10= 50 marks)
5	OE-2 (Minor)	SCIENCE – MATHEMATICS	2 (40+10= 50 marks)
6	VSC-1	OFFICE AUTOMATION-I	2 (40+10= 50 marks)
7	SEC-1 (Minor)	COMPUTER ASSEMBLY & TROUBLESHOOTING PART-I	2 (40+10= 50 marks)
8	AEC-1 (Minor)	ENGLISH FOR BUSINESS COMMUNICATION-I	2 (40+10= 50 marks)
9	VEC-1 (Minor)	DEMOCRACY, GOOD GOVERNANCE	2 (40+10= 50 marks)
10	IKS-1 (Minor)	ANCIENT INDIAN MANAGEMENT	2 (40+10= 50 marks)
11	CC-1 (Minor)	NSS/SPORTS/CULTURE/HEALTH WELLNESS/FITNESS/YOGA	2 (40+10= 50 marks)
		22 Credits	22

Shikshan Mandal, Karad's

Mahila Mahavidyalaya, Karad

NEP-2020 (2.0): Course Groups for B.Com.IT Sem-II (Level 4.5) under Faculty of Commerce & Management

Sr. No.	COURSE	DSC-I	CREDITS
1	DSE 4 (Major)	PROGRAMMING IN C PART-II (Mandatory)	2 (40+10= 50 marks)
2	DSE 5 (Major)	OPERATING SYSTEM (Mandatory)	2 (40+10= 50 marks)
3	DSE 6 (Major)	LAB ON DSC-4 & VSC-2 (Mandatory)	2 (40+10= 50 marks)
4	DSM 1 (Major)	INSURANCE	2 (40+10= 50 marks)
5	OE-3 (Minor)	HUMANITIES – MICRO ECONOMICS	2 (40+10= 50 marks)
6	OE-4 (Minor)	SCIENCE – MATHEMATICS	2 (40+10= 50 marks)
7	VSC-2	OFFICE AUTOMATION-II	2 (40+10= 50 marks)
8	SEC-2 (Minor)	COMPUTER ASSEMBLY & TROUBLESHOOTING PART-II	2 (40+10= 50 marks)
9	AEC-2 (Minor)	ENGLISH FOR BUSINESS COMMUNICATION-II	2 (40+10= 50 marks)
10	VEC-2 (Minor)	ENVIRONMENTAL STUDIES	2 (40+10= 50 marks)
11	CC-2 (Minor)	NSS/SPORTS/CULTURE/HEALTH WELNESS/FITNESS/YOGA	2 (40+10= 50 marks)
		22 Credits	22

MAHILA MAHAVIDYALAYA, KARAD

11.3.2 B.Sc. Part II (NEP 2.0) For the academic Year 2025-26, admissions shall be as per NEP 2.0 guidelines and subject baskets provided by Shivaji University, Kolhapur.

11.4.2 B.Com. (I.T.) Part III - Subjects: Semester V

Course Code	Title of Paper	Credit	Internal	External	Total
CC 501	Computer Network	4	30	70	100
CC 502	Cost Accounting	4	30	70	100
CC 503	Data Warehousing & Data Mining	4	30	70	100
CC 504	Elective – I (Commerce) 1. Human Resource Management 2. Principle of Investment 3. Bank Management	4	30	70	100
CC 504	Elective – II (Information Technology) 1. Python 2. Advance Excel 3. Application Development Tools	4	30	70	100
AEC 506	Financial Technologies	2	50	-	50
CCL 507	Lab based on DSE 505	2	-	50	50
CCC	Constitution of India	-	-	-	-
Total		24	150	450	600

11.4.3 B.Com. (I.T.)PartIII - Subjects: SemesterVI

Course Code	Title of Paper	Credit	Internal	External	Total
CC 601	Information System Security & Audit	4	30	70	100
CC 602	Java Programming	4	30	70	100
GE603	Elective – I (Commerce) 1. Organisational Behavior 2. Management Accounting 3. Cooperative Development	4	30	70	100
DSE 604	Elective – II (Information Technology) 1. E-Commerce 2. ERP 3. Cloud Computing	4	30	70	100
AEC 605	Soft Skills & Personality	4	50	-	50

MAHILA MAHAVIDYALAYA, KARAD

	Development				
CCL 606	Lab based on CC 602	2	-	50	50
CCL 607	Major Project	4	-	100	100
SEC – II	Skill Enhancement Course	-	-	-	-
Total		24	170	430	600

11.5 POST GRADUATE COURSE:

M.A. (Geography) (NEP)

The college runs M.A. / M.Sc. course in Geography. The intake capacity is 20. The fees are according to the rules and regulations of Shivaji University, Kolhapur. Students must clear Entrance Test conducted by Shivaji University, Kolhapur to enrol for the course.

12. OJT – On Job Training / Internship

- **Duration:** 1 Month
- **Fees:** Free
- **Certificate**
- **Areas:** Biogas Systems, Composting Technologies, Zero- Waste Systems
- **Internships:** Biogas Systems, Composting Techniques, Industrial Waste Management, Vermicomposting, Mushroom Cultivation
- **Special Features:**
 - ✓ Hands on Training
 - ✓ Customized & Flexible
 - ✓ Practical Projects
 - ✓ Experienced Mentors
 - ✓ Certificate on Completion

13 Fee Chart

		Grantable						Non Grantable								
Sr. No.	Details	BA I	BA II	BA III	Bcom I	Bcom II	Bcom III	BA III(Psy)	BSc I	BSc II	BScIII	BCom IT I	Bcom IT II	Bcom IT III	MA I	MA II
1	Admission Fee	20	20	20	20	20	20	20	20	20	20	20	20	20	20	20
2	Library Fee	100	100	100	100	100	100	100	100	100	100	100	100	100	100	100
3	Gymkhana Fee	150	150	150	150	150	150	150	150	150	150	150	150	150	150	150
4	Development Fund	300	245	225	300	245	225	225	300	295	150	250	245	225	225	225
5	Laboratory Fee								1000	1000	125	1000	1000			
6	Tution Fee	800	800	800	800	800	800	5300	11000	11000	13750	7500	7500	7500	7700	7700
7	Other Fee (SUK)	786	936	711	786	936	711	711	1286	1436	711	786	936	711	1061	1011
	Total	2156	2251	2006	2156	2251	2006	6506	13856	14001	15006	9806	9951	8706	9256	9206
	Other Fee															
		Grantable						Non Grantable								
Sr. No.	Details	BA I	BA II	BA III	Bcom I	Bcom II	Bcom III	BA III(Psy)	BSc I	BSc II	BScIII	BCom IT I	Bcom IT II	Bcom IT III	MA I	MA II
1	ERP Charges	250	250	250	250	250	250	250	250	250	250	250	250	250	250	250
2	Extra Curricular Fee	50	50	50	50	50	50	50	50	50	50	50	50	50	50	50
3	Student Welfare	50	50	50	50	50	50	50	50	50	50	50	50	50	50	50
4	Magazine Fee	100	100	100	100	100	100	100	100	100	100	100	100	100	100	100
5	I Card	50			50				50			50			50	
6	BorrowCard	25	25	25	25	25	25	25	25	25	25	25	25	25	25	25
7	Bonafide	19	19	19	19	19	19	19	19	19	19	19	19	19	19	19
8	Environment Science		155			155				155			155			
9	Skill Development Fee		1000	1000		1000	1000	1000								
		544	1649	1494	544	1649	1494	1494	544	649	494	544	649	494	544	494
	G.Total	2700	3900	3500	2700	3900	3500	8000	14400	14650	15550	10350	10600	9200	9800	9700

MAHILA MAHAVIDYALAYA, KARAD

Note:

- Education Fees of the college and the rules regarding it might change any time. Students shall pay full fees while filling in Examination Form.
- Practical Fee for B.A. I and II Home Science and Physical Education shall be Rs. 75/--.
- Practical Fee for B.A. III Psychology and M.A. / M.Sc. Geography shall be Rs. 150/--.
- Since the intake capacity of the College Hostel is limited, students who require hostel facility should confirm their admission by duly filled in Hostel Form.

14. Employment Oriented Courses provided by the Centre for Skill Development:

Sr.No.	Name of the EOC	Duration	Sr.No.	Name of the EOC	Duration
1	Spoken English	3 Months	8	Tally with GST	3 Months
2	CCIT	45 Days	9	Balwadi Teachers' Training course	6 Months
3	E- Banking	6 Months	10	Psychological Counselling	3 months
4	Fashion Designing	2 Months	11	Introduction to Income Tax	3 Months
5	Beauty Care	2 Months			
6	GIS	5 weeks			

14.1 : Value Added courses - Mahila Mahavidyalaya Karad has planned MOUS with renowned Tranining Center for conducting following range of value added courses. These courses are designed to enhance students skills and employability while they pursue their degree programmes. The fees for these coruses are minimum. The courses are as follows -

1. Digital Film making (Weeking Training)

2. Food Industry Entrepreneurship Development Progremme

3. Voging (Life style, Travel, Food Workshop))

4. Social Media Marketing for Business (Short Duration course)
5. Linkedin Optimazation Training Crs.

6. Video Editing Course

7. E - Commerce & Govt. Tendring

8. Advance Certificate Programme in Event Management

In addition, the Centre shall organize following courses for very short duration:

- 1 Mehandi

2 Fabric Painting

3 Bags, Purses and Pouches Making

4 Artificial Flowers Making

5 Cakes &Pastries Making

6 Herbal Cosmetology

7 Hindi Conversation

8 Embroidery
- 9 Eco-Friendly Ganesh Idol Making

10 Imitation & Pearl Jewellery

11 Rakhi Making

12 Ceramic Art

13 Masalas Making

14 Paper Lantern Making

15 Hindi Translation

MAHILA MAHAVIDYALAYA, KARAD

15. Facilities in the College:

15.1 Library

Libraries are nucleus of the college. As they are engaged in social and intellectual activities, they are truly the centre of learning. The wi-fi enabled Central library of Mahila Mahavidyalaya is well equipped with a large collection of books (fiction and non-fiction), journals (both national and international), biographies, encyclopaedias, dictionaries, art books, maps, etc. The library is developed considering the changing time and needs and it boasts of approximately 25519 books. Its website – mcklibrary@weebly.com., in-house library system software and a barcode printer have made the library more resourceful for the students and faculty. E-books, e-journals and INFLIBNET are made available to the members. It is e-linked with the Shivaji University, Kolhapur. Students as well as teaching and non-teaching staff avail of library facility Outsiders too can avail of the facility on depositing Rs. 1000/-only. Teaching faculty can borrow 20 books at a time. Students can borrow one book on their Borrow Card while meritorious students (those who have got 75% and above marks) can borrow 2 books at a time. Meritorious but needy students can avail of the Book- Bank facility for a year. Other students who wish to avail of Book- Bank facility also can borrow all text-books for the academic year. The librarian conducts a Library Orientation Session and organises a Book Exhibition every year. There is a separate Study-Room with computer facility adjoining the library.

Library Hours:

Monday to Saturday	8.00 am to 04.00 pm
Vacations (Diwali and Summer)	Same as above

15.2 Hostel:

The college offers efficient, well-managed and clean hostel accommodation to out-of-town students. It is located in the city and is at walkable distance. It is well equipped with the necessary amenities (entertainment room, mess and dining hall, clean drinking water, Solar Water Heater, etc.).

15.3. Canteen:

College canteen is set up in the premises and offers snacks and beverages at affordable prices to the students and faculty of Mahila Mahavidyalaya and other sister concerns of Shikshan Mandal, Karad.

15.4. Computer Lab:

A special well equipped Computer Lab with internet facility has been set up in the college and is used extensively by the students and faculty. The facility is provided free of cost.

15.5 Language Lab:

A well-equipped Language Lab has been set up in the college and is used extensively by the students and faculty. The facility is provided free of cost.

MAHILA MAHAVIDYALAYA, KARAD

15.6 NTA Lab:

NTA (National Testing Agency) centre conducts entrance examinations for admissions/fellowship in higher education institutions and SWAYAM courses.

15.7. Gymnasium:

A well-equipped gym is set up in the campus. Students can avail of this facility in the college hours.

15.8. Ground:

College ground as well as the ground that belongs to Tilak High School is used for sports events.

15.9 Drinking water:

Water cooler has been installed to provide clean and cool drinking water

15.10 Sanitary Napkin Vending Machine and Incinerator:

The college is always concerned about the health and hygiene of the students and hence it has installed a Sanitary Napkin Vending Machine and Incinerators. It provides sanitary napkins at affordable rate.

16: Courses under National Skill Qualification Framework (NSQF):

In accordance with the vision of the college – 'Empowerment of Girl Students in Pursuit of knowledge, values and self-reliance', we have incorporated into their academic courses the entrepreneur awareness and vocation skills which will enable students to prepare for opportunities in jobs or entrepreneurship and thereby attain economic empowerment. The students will complete their educational programme along with learning vocational skills for self-reliance. The department of Home Science, English and Physical Education offer following UGC funded NSQF (National Skill Qualification Framework) Courses:

1. Diploma in Food Processing
2. Certificate Course in Communication Skills in English
3. Certificate Course in Yoga and Fitness

17. Employment Oriented Courses Conducted in the College:

The Centre for Skill Development conducts various courses under two heads viz. Employment Oriented Courses (EOC) which primarily focus on employment generation and Skill Development Courses (SDC) which include courses of short duration. The courses aim at developing various aspects of their personality like language proficiency, employment generation skills, soft skills, skills that will develop their social awareness, skills that will enable them to have a healthy body and mind etc.

18. Balwadi/Anganwadi Teachers' Training course:

Balwadi/Anganwadi Teachers' Training course is approved by Shivaji University, Kolhapur. Interested students can enrol for the course while doing their graduation in the college. The classes are conducted after college hours. Students must appear for both written and practical exam at the end of the course of the course to receive a certificate from the University.

MAHILA MAHAVIDYALAYA, KARAD

19. Extension Programmes:

19.1 Competitive Examination Guidance Centre

Realizing the interest of the students and to train them to enter the civil sector services, banking sector, etc. the college with the help of its parent institution, Shikshan Mandal, Karad has set up a full-fledged training centre that guides aspiring youth of Karad and its periphery. The centre has necessary infrastructure, qualified faculty and good study material. It provides guidance by organising lectures of eminent scholars, those who have cleared the exam and college faculty for various subjects. The library holds a separate section for books, periodicals, etc. required for the preparation of these exams.

19.2. National Service Scheme (N.S.S.):

The NSS unit of the college attempts to inculcate the spirit of voluntary work among students and teachers through sustained community interactions. It brings the college closer to the society to achieve community development. It aims at imbibing in the students the spirit of national integration, dedication for social services, dignity of labour, and leadership. The college boasts of remarkable record of NSS activities in the Shivaji University, Kolhapur. The NSS volunteers also participate in various activities and programmes conducted by the University, Karad Municipality, Venutai Chavan Sub-Divisional Hospital, Karad and many NGOs in and around Karad. The college has been conducting Special Camp Programme in various adopted villages since its inception i.e. 1986. The enrolment to the units is done according to the guidelines laid down by the Shivaji University, Kolhapur. The volunteers who enroll for NSS for two consecutive years and attend one Special Camp get a Certificate from the University and benefit of 10 marks in their examinations or preference in any government job. Total Strength of the unit is 100.

19.3. Students Counselling Centre:

The centre provides following services:

- Personal counselling for better personal and social adjustment
- Personal counselling for selection of career

19.4 Placement Cell:

The cell attempts to groom the students, and guide them for choosing the appropriate career path, impart knowledge and skill for meeting the requirement of the recruitment process and on boarding the human resource. The cell promotes career counselling through guidance, lectures, programmes by suitable resources. It helps students to define their career interest through individual expert counselling.

19.5 Equal Opportunity Centre:

Equal Opportunity Centre (EOC) is set up to effectively implement policies and programmes for disadvantaged groups, provide guidance and counselling with respect to academic, financial, social and other matters. It helps enhancing the diversity within the campus. The needs of socio-economically disadvantaged groups (SEDGs) are addressed as emphasized in the National Education Policy (NEP) 2020.

MAHILA MAHAVIDYALAYA, KARAD

19.6 Lokmanya Green Club:

Lokmanya Green Club works for creating environmental awareness among the college students for environmental improvement and to inculcate the culture of eco-friendliness and environmental conservation among them by organising

20. Students Welfare:

20.1. Students Welfare Fund:

Students from economically backward background are offered help in the form of money and kind twice (once in each semester) in the academic year. The needy students can submit an application to the Principal regarding examination fee, admission fee, fee for the courses run in the college, etc.) and in kind (e.g. books, college bag, umbrella, cycles, etc.). Students should note that the help is rendered to the students considering their overall behaviour, academic progress, and attendance in the class.

20.2 Scholarships:

- Students belonging to Economically Backward Class (Parent's Annual Income - up to Rs. 8 lakh only) shall receive 'Rajarshi Shahu Maharaj Shikshan Shulk Scholarship'.
- The students belonging to S.C./S.T./V.J./N.T. category (Parent's Annual Income - up to Rs. 8 lakh only) are eligible for Government of India Post Matric Scholarship
*Students must submit required documents along with a Photocopy of Caste Certificate (Two attested photocopies)
- Students seeking Government of India Post Matric Scholarship and Freeship should fill online forms and submit hard copy of the same along with necessary documents on website:

<http://Mahaeschot.Maharashtra.gov.in/escholarship/login.aspx> or

<http://www.scholarships.gov.in>

- **Minority Scholarship :** Minority students (Muslim/ Christian/ Sikh/ Bauddh/ Parsi) seeking scholarship should fill their online forms and submit hard copy of the same along with necessary documents in the college office. website: www.dhepune.gov.in/scholarship
Following Scholarships and Freeships are available to the students in the college. Eligible students should apply for them as and when they are informed. For further information students are expected to enquire to the concerned clerk in the office or meet the coordinator of the Scholarships Committee-
- Government scholarship for students belonging to SC/ST/NT/OBC, etc. students
- State govt. Open Merit Scholarship
- Scholarship for Handicap students

MAHILA MAHAVIDYALAYA, KARAD

- Central Govt's A-Hindi Bhashik Scholarship
- Shivaji University Merit Scholarship and other Scholarships
- Central Sector Scheme of Scholarship for College and University Students
- Government Open Merit Scholarship for Meritorious Students
- Government of India National Scholarship
- Ekalavya Arthik Sahayya Yojana' for Post Graduate Students

Note:

- Application for many of the above mentioned scholarships are expected to be sent online by the students themselves. Students may contact the office or the coordinator of the Scholarships Committee for guidance.
- The college is not at all responsible for the non-receipt of scholarships or Freeships for which students have applied.
- Students admitted in non-grant classes shall not get the benefit of freeship facility. They have to pay admission and education fees as per the University rule.
- Legal action (shi.s. 1-674-95-6-5-1995) shall be taken against the students who submit fake certificate of income/caste.
- The students who fail to submit the application form of scholarships or Freeship within a stipulated time shall have to pay full fees.
- Changes in the rules of Scholarships and Freeships by the Government shall be immediately implemented.

20.3 Students' Health Check-up:

Students' Health Check up and follow up has been a sustained activity of the college since 1994. Since most of our students come from rural area, majority of them are unaware about health issues like - reproductive health, hygiene, communicative diseases, oral health, healthy food and dietary habits. Hence throughout the year to ensure physical, mental, psychological and social wellbeing of students various activities are organized with the voluntary cooperation from the Krishna Institute of Medical Sciences, Karad, and Lioness Club, Karad with whom the college has done MOU. The college has also formed Red Ribbon Club for AIDs awareness programme in association with KIMS, Karad. Along with health check up, lectures on the aforementioned issues are conducted all the year round.

21. Shivaji University Kolhapur Schemes:

Scan the given QR Code to procure the information about the following schemes of Shivaji University, Kolhapur. The Schemes are :



MAHILA MAHAVIDYALAYA, KARAD

1. शिवाजी विद्यापीठ प्रोत्साहनपर क्रीडा शिष्यवृत्ती योजना
2. कल्याण निधी योजना
3. वैद्यकीय अपघात मदत निधी योजना
4. Research Sensitization Scheme
5. शिवाजी विद्यापीठ संलग्न महाविद्यालयीन नियतकालीक स्पर्धा
6. Baroda Achievers Award
7. The President of India Medal for General Proficiency, Shivaji University
8. Shivaji University Merit Scholarship
9. Main Reading Room Facility for Students of UPSC/ NET/ SET/ CA/CS/ICWA
10. Walk in Users / Reference Facility
11. Youth Festival

22. Food Festival:

Food Festival is the unique activity of the college organised by Department of Home Science every year since 1993-94 with an innovative approach to develop informally the traditional culinary art of cookery. Various food specialities prepared by the students are exhibited, sold and enjoyed. It is an exercise in food catering, marketing skills, entrepreneurship and art in students. The department also organises various competitions like mehendi, rangoli, hair-style, handicrafts, flower arrangement, etc. during the festival to encourage the artistic approach in the students.

23. Annual Sports Meet:

The Interclass Sports Meet is organised annually to encourage students to participate in sports events like – Kabaddi, Kho-kho, Long jump, discus throw, etc. and thereby motivate them to participate in zonal and inter-zonal sports events.

24. Students' Council:

The role of the Students Council is to look after the welfare of the students and to promote extra-curricular activities in the college. Members of the council are expected to bring ideas, requests, and feedback to the meetings. Democratic process is used to give students a voice and make decisions in creating a year-long calendar. Students council is formed in the college according to the statutes of Shivaji University, Kolhapur and the decisions are taken collectively according to the University guidelines. President and Secretary represent the students in the CDC.

25. Gymkhana:

Gymkhana aims at the overall development of students through sports and cultural activities. It offers opportunities to students to play indoor and outdoor games. Following are some of its activities:

MAHILA MAHAVIDYALAYA, KARAD

- Organization of Annual Cultural Programme
- Self Defence Course for students
- Inter Class Annual Sports Meet
- Coaching for cricket and Soft Ball
- Participation of students in zonal and inter-zonal sports competitions. Some students have given outstanding performance in national and Asian sports events.
- Participation in Youth Festival. Students have won prizes in the events: group songs, street plays, mime, elocution and quiz. Financial aid is rendered to the players representing the college at the University, State, and National level. The players may contact Head, Gymkhana.

26. Alumni Association:

The college has a registered Alumni Association which aims at reaching, engaging and serving all alumni and present students by networking with one another to foster a life-long intellectual and emotional connection between the college and its graduates. The Alumni are expected-

- to establish a meaningful association with the Alma Mater in order to stay involved in its activities.
- to contribute towards the development of the college in every possible way and to encourage values of modern education and the ideals for which the college stands.
- to work towards the goal of gender equality and empowerment of women/girls in their academic, social and cultural activities.

Students are required to submit the duly filled in form of the Alumni Association on leaving the college after graduation or leaving the college for a Third Year Course to the Coordinator of the Association.

27. Parents-Teachers Association:

The Parents -Teachers Association is an organisation of the parents of all students of the College and the teaching faculty that aims at establishing a positive and constructive link between all the stake-holders. It is formed to provide a common forum for interaction of parents and teachers so as to improve facilities for academic excellence, to encourage parents' involvement in the activities of the institution, to evaluate the effectiveness of the academic activities of the students and the college. The Principal is the president of the Association. The vice president is elected from the parents.

28. Statutory Committees in the College:

28.1: College Development Committee: The CDC aims at preparing a comprehensive development plan of the college regarding academic, administrative and infrastructural growth and empowers college for excellence in academic, co-curricular and extra –curricular activities.

MAHILA MAHAVIDYALAYA, KARAD

28.2. Internal Quality Assurance Cell (IQAC):

The IQAC being an integral part of the college works towards realizing the goals of quality enhancement by developing a system for improvement in different aspects of functioning of the college. The IQAC assures the stakeholders i.e., students, parents, teachers, staff, management, funding agencies and society in general of the accountability and transparency in the quality management system of the institution and its concern for ensuring quality of education being imparted. All stake holders are expected to cooperate in enhancing overall quality of the institution.

28.3 Special Cell Standing Committee:

The aims and objectives of the Special Cell Standing Committee are:

- to implement the reservation policy for SC/ST,VJ/NT/OBC/SBC category candidates in the College.
- to inform and guide them about various government schemes, scholarships and freeships regularly.
- to boost the confidence among them to participate in various academic activities, sports, cultural programme, social activities, etc.
- to verify the Rosters maintained by college according to Government rules.
- to work as the Grievances Redressal Cell for these candidates and render them necessary help in solving their academic and other problems.
- to take cognizance of the complaints received from employees and students belonging to reservation class and help in redressing their grievances.

28.4 Students' Grievances Cell:

The committee has been set to redress the academic, financial, personal, social, etc. grievances of the students. For the convenience of the students, a complaint box has been installed in the college. The committee takes every possible effort to resolve the grievances amicably. The matters discussed in the committee meetings are kept confidential.

28.5 Anti-Ragging Committee: The committee is constituted as per the directives of Shivaji University, Kolhapur in accordance with the guidelines of the Government of Maharashtra. The students can contact the committee if they encounter ragging from other students.

28.6 Internal Complaints Committee:

The committee is set up to create and maintain an environment free from sexual harassment in the college. It is constituted under Sexual Harassment of women at work place under (Prevention, Prohibition and Redressal Act, 2013). The college strongly disapproves of any conduct that constitutes sexual harassment. All students, faculty, and staff members are advised to report any matter related to sexual harassment to the Internal Complaints Committee. All complaints shall be thoroughly investigated and appropriate action shall be taken promptly. The Committee shall maintain confidentiality within the limits of the law and will not disclose sensitive information to any individual except for those who have a specific need to know.

29. Right to Information:

The committee has been set up in the college as per the directives of the Government and University to promote transparency and accountability in the working of every public authority.

MAHILA MAHAVIDYALAYA, KARAD

30. Discipline and Code of Conduct:

Preamble: All the students must know that it is binding upon them to abide by this code of Ethics and conduct and the rights, responsibilities and the restrictions emanating from it. The aim of this Code of Conduct is to initiate discipline among students and provide for a system which promotes growth through individual and collective responsibility. All the students are expected to be conversant with this code. It is displayed on the college website www.mahilamahavidyalaya.com

30.1 Code of Conduct for Students:

- As per the University rules, students must have a minimum of 75% attendance to all classes.
- Students must carry their identity cards on the campus or while representing the college at other places.
- All students must uphold academic integrity, respect all persons, and their rights.
- Students must not intentionally damage or destroy the college property or property of other students and/ or faculty.
- Students must not engage in any disruptive activity on / off the campus.
- Indecent, lewd behaviour, unreasonable noise, disruption in the college is liable for strict action.
- Indulging in harassment of other students / staff and ragging of other students is liable to punishment according to the law.
- Theft / abuse / tampering of physical, electronic, ICT and other facilities on the college campus is liable to punishment.
- Violation of the rules laid down by the library shall also come under misconduct.
- Use of ICT facilities must be made for educational purposes only.
- Students must carry their identity cards with their photographs fixed thereon in the college or while representing the college at other places. Identity cards without photograph, stamp and signature of the Principal shall be considered invalid.
- In the event of discontinuation or transfer to another institution, the student shall be required to clear all pending dues, if any.
- Students should not organize meetings, processions without permission of the college.
- Students shall not interact, on behalf of the College with media representatives or invite media on the campus without prior permission.
- Students should use social media carefully and responsibly. They should not post derogatory comments on other persons from the College / on the college in social media that may adversely affect the interest and reputation of the College.
- Any misconduct will be dealt with by the Discipline Committee and disciplinary action shall be taken after ascertaining the misconduct and according to the nature of misconduct.

30.2 Code of Conduct for Teachers:

- All teachers shall devote themselves diligently to their work and utilize their time with absolute integrity to the service of the college.
- All teachers shall comply with the provisions of the Act, Government Resolutions, and Statutes issued by the UGC, the Central and the State Government.

MAHILA MAHAVIDYALAYA, KARAD																																											
<ul style="list-style-type: none">• All teachers shall perform their academic duties and work related to examinations as assigned to them.• No teacher shall remain absent from the institution without leave or the previous permission of the Principal.• No teacher shall discriminate against any student on political grounds or for reasons of caste, creed, sect, religion, sex, nationality, languages, or reasons of personal nature.• No teacher shall directly or indirectly do anything that may constitute sexual harassment of student/s and/or colleague/s and/or employee/s or any person at his/her workplace.• No teacher shall possess any weapon, narcotics, liquor or any other objectionable material in the college or Sanstha premises.• A teacher must take written permission of the Sanstha before accepting any political and social responsibility.• No teacher shall misuse social media and ICT facility provided by the college during working hours at work place.																																											
31. Full-Time Faculty																																											
<table><tr><th>Name of the Teacher</th><th>Qualification</th><th>Designation</th><th>Subject</th></tr><tr><td>Dr. Smt. Snehal R. Prabhune</td><td>M.A., Ph.D., SET</td><td>I/C Principal, Professor & Head</td><td>English</td></tr><tr><td>Dr.Shri. Parag S. Sontakke</td><td>M.A., M.Phil., Ph.D.</td><td>Vice Principal &Asso. Professor</td><td>English</td></tr><tr><td>Dr.Shri. Suhaskumar V. Bobade</td><td>M.A.M.Phil. Ph.D.</td><td>Professor & Head</td><td>Marathi</td></tr><tr><td>Dr.Shri. Arjun G. Ohal</td><td>M.A., M.Phil. Ph.D.</td><td>Asso. Professor& Head</td><td>Geography</td></tr><tr><td>Dr. Smt. Ujjwala N.Tathe</td><td>M.A., M.Phil. Ph.D. (SET)</td><td>Professor</td><td>English</td></tr><tr><td>Shri. Akhilesh V. Shinde</td><td>M.A., M.Phil. (SET, NET)</td><td>Asst. Professor</td><td>Sociology</td></tr><tr><td>Shri. Vilas S. Surve</td><td>M. A. (SET)</td><td>Asst. Professor</td><td>Marathi</td></tr><tr><td>Smt. Vaishali S. Subhedar</td><td>B.Com.,M.Lib.,I.Sc. (SET)</td><td>Librarian</td><td>--</td></tr><tr><td>Shri. Dr. P.V. Misale</td><td>M.Ped. Ph.D. SET</td><td colspan="2">Director, Physical Edu.</td></tr></table>				Name of the Teacher	Qualification	Designation	Subject	Dr. Smt. Snehal R. Prabhune	M.A., Ph.D., SET	I/C Principal, Professor & Head	English	Dr.Shri. Parag S. Sontakke	M.A., M.Phil., Ph.D.	Vice Principal &Asso. Professor	English	Dr.Shri. Suhaskumar V. Bobade	M.A.M.Phil. Ph.D.	Professor & Head	Marathi	Dr.Shri. Arjun G. Ohal	M.A., M.Phil. Ph.D.	Asso. Professor& Head	Geography	Dr. Smt. Ujjwala N.Tathe	M.A., M.Phil. Ph.D. (SET)	Professor	English	Shri. Akhilesh V. Shinde	M.A., M.Phil. (SET, NET)	Asst. Professor	Sociology	Shri. Vilas S. Surve	M. A. (SET)	Asst. Professor	Marathi	Smt. Vaishali S. Subhedar	B.Com.,M.Lib.,I.Sc. (SET)	Librarian	--	Shri. Dr. P.V. Misale	M.Ped. Ph.D. SET	Director, Physical Edu.	
Name of the Teacher	Qualification	Designation	Subject																																								
Dr. Smt. Snehal R. Prabhune	M.A., Ph.D., SET	I/C Principal, Professor & Head	English																																								
Dr.Shri. Parag S. Sontakke	M.A., M.Phil., Ph.D.	Vice Principal &Asso. Professor	English																																								
Dr.Shri. Suhaskumar V. Bobade	M.A.M.Phil. Ph.D.	Professor & Head	Marathi																																								
Dr.Shri. Arjun G. Ohal	M.A., M.Phil. Ph.D.	Asso. Professor& Head	Geography																																								
Dr. Smt. Ujjwala N.Tathe	M.A., M.Phil. Ph.D. (SET)	Professor	English																																								
Shri. Akhilesh V. Shinde	M.A., M.Phil. (SET, NET)	Asst. Professor	Sociology																																								
Shri. Vilas S. Surve	M. A. (SET)	Asst. Professor	Marathi																																								
Smt. Vaishali S. Subhedar	B.Com.,M.Lib.,I.Sc. (SET)	Librarian	--																																								
Shri. Dr. P.V. Misale	M.Ped. Ph.D. SET	Director, Physical Edu.																																									
32. Non-Teaching Staff:																																											
<table><tr><th>Name</th><th>Designation</th><th>Name</th><th>Designation</th></tr><tr><td>Smt. Uma V. Mane</td><td>Head Clerk</td><td>Shri. Bhairu S. Koli</td><td>Library Attendant</td></tr><tr><td>Shri. Sudhir R. Kadam</td><td>Senior Clerk</td><td>Smt. Gauri A. Veer</td><td>Library Attendant</td></tr><tr><td>Shri. Nitin D. Deshpande</td><td>Junior Clerk</td><td>Shri. Sandeep B. Pawar</td><td>Library Attendant</td></tr><tr><td>Smt. Aparna Joshi</td><td>Accountant</td><td>Shri. Jayant B. Dhagale</td><td>Peon</td></tr></table>				Name	Designation	Name	Designation	Smt. Uma V. Mane	Head Clerk	Shri. Bhairu S. Koli	Library Attendant	Shri. Sudhir R. Kadam	Senior Clerk	Smt. Gauri A. Veer	Library Attendant	Shri. Nitin D. Deshpande	Junior Clerk	Shri. Sandeep B. Pawar	Library Attendant	Smt. Aparna Joshi	Accountant	Shri. Jayant B. Dhagale	Peon																				
Name	Designation	Name	Designation																																								
Smt. Uma V. Mane	Head Clerk	Shri. Bhairu S. Koli	Library Attendant																																								
Shri. Sudhir R. Kadam	Senior Clerk	Smt. Gauri A. Veer	Library Attendant																																								
Shri. Nitin D. Deshpande	Junior Clerk	Shri. Sandeep B. Pawar	Library Attendant																																								
Smt. Aparna Joshi	Accountant	Shri. Jayant B. Dhagale	Peon																																								
<div>● ● ● ●</div>																																											
<div>PROSPECTUS - 2025 - 26</div> <div>... 32</div>																																											

Letter of Guarantee regarding Attendance

To,
The Principal,
MahilaMahavidyalaya, Karad

Subject: A letter of Guarantee regarding Attendance

Respected Madam / Sir,
I -----
-----am enrolling for ----- course. As per the
University norms, my attendance should be 75% in the college. I am well
aware that if I don't maintain the required percentage, I won't be able to fill in
the examination form. Hence I give guarantee to attend the college regularly.

(Sign & Name of the Student)

DECLARATION

As per the provision in the Maharashtra Public University Act 2016, I Smt. /
Shri. -----applied / admitted for ----
----- course in the subject of ----- hereby sign a
declaration to the effect that, I submit myself to the disciplinary jurisdiction of
the Vice- Chancellor or any other authority or body concerned and shall
observe and abide by the rules or supplementary rules made by the said
officers, authorities or bodies in that behalf from time to time.

Place : _____

Signature of the Applicant _____

Date : / /20